

**SOUTH GLOUCESTERSHIRE COUNCIL**  
**(Trinity Lane, Chipping Sodbury) (Temporary Prohibition of Use by Vehicles)**  
**Order 2022**

Notice is hereby given that South Gloucestershire District Council in pursuance of the provisions of section 14 of the Road Traffic Regulation Act 1984 as amended intends to make an order the effect of which will be to close, temporarily, to vehicles that length of Trinity Lane which extends from a point 42 metres north of its junction with St Johns Way in a northerly direction for a distance of 40 metres.

This order is required for the following reason: in connection with water main renewal works. The order will be operative from 1 August 2022 for a maximum period of eighteen months. The closure however may not be implemented for the whole of the period but only when traffic signs are in position and only for so long as is necessitated by the works which are anticipated to be of **11 days** duration.

**No alternative route available**

PO Box 1953,  
Bristol,  
BS37 0DB

John McCormack  
Monitoring Officer and Head of Legal,  
Governance and Democratic Services

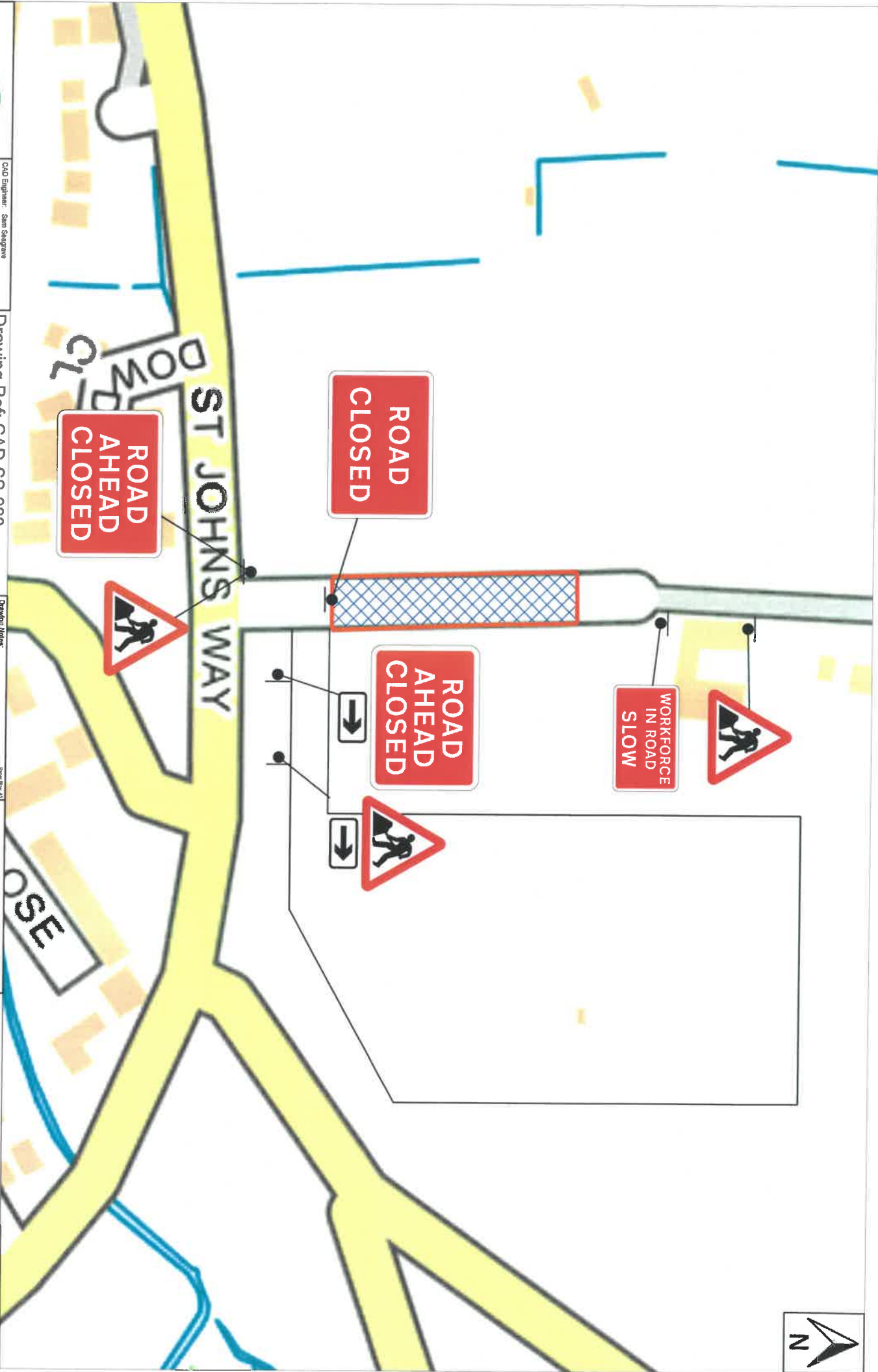

Drawing Ref: CAD-SS-993

Client:	Network Plus
Contact:	Terry Chishall Hunt
Location:	Trinity Lane Chipping Sodbury BS37 6BX
Date Drawn:	21/04/2022
Project Number:	2530298

Produced By:	ES3	Checked By:	LKJ
Hoole Highways Traffic Management Ltd Tel: 01934 726116 Email: CAD@hoolehghighways.co.uk			

Key: Client: Road Sign Signs Works Area Temporary Position Temporary Sign	Also Required Callout to use with Chipping Sodbury Gate Club as this is the only access route in or out New housing development was manually drawn in This site is a residential area Permanent Sign No Parking Signs
------------------------------------------------------------------------------------------	--------------------------------------------------------------------------------------------------------------------------------------------------------------------------------------------------------------------------------------

**TRAFFIC MANAGEMENT NOTES:**

- 1) All temporary traffic management shall be in accordance with Chapter 8 of the Traffic Signs Manual, A Code of Practice.
- 2) All temporary traffic management shall be undertaken by a specifically qualified operator in accordance with the 1930 (Temporary Traffic Signs) Regulations.
- 3) All temporary traffic management shall be undertaken in accordance with the 1930 (Temporary Traffic Signs) Regulations.
- 4) Signage shall be undertaken in accordance with the 1930 (Temporary Traffic Signs) Regulations.

