

SOUTH GLOUCESTERSHIRE COUNCIL
(Dodington Lane, Dodington) (Temporary Prohibition of Use by Vehicles) Order 2021

Notice is hereby given that South Gloucestershire District Council in pursuance of the provisions of section 14 of the Road Traffic Regulation Act 1984 as amended intends to make an order the effect of which will be to close, temporarily, to vehicles that length of Dodington Lane which extends from its junction with Claypit Hill in a south easterly direction for a distance of 150 metres.

This order is required for the following reason: in connection with BT overhead structures works. The order will be operative from **30 November 2021** for a maximum period of eighteen months. The closure however may not be implemented for the whole of the period but only when traffic signs are in position and only for so long as is necessitated by the works which are anticipated to be of a **1 day duration**, between the hours of 9.30am and 3.30pm.

Alternative route: Gibbs Lane, Sodbury Lane, B4465, Old Parish Lane and vice versa

PO Box 1953,
Bristol,
BS37 0DB

John McCormack
Monitoring Officer and Head of Legal,
Governance and Democratic Services

Key	01A ADVANCED WARNING ACCESS TO ROAD AHEAD CLOSED ON [DAY(S)] FROM [] TO []	01 ROAD CLOSED	02 Diverion ENDS	03 Diverion ENDS	04 Diverion traffic	05 Diverion traffic	06 Diverion traffic	07 Diverion traffic	08 Diverion traffic	09 Diverion traffic	10 ROAD AHEAD CLOSED	11 Diverion traffic	12 Diverion traffic	13 Diverion traffic	14 Diverion traffic	15 Diverion traffic
------------	-------------------------------------------------------------------------------------------------	--------------------------	----------------------------	----------------------------	-------------------------------	-------------------------------	-------------------------------	-------------------------------	-------------------------------	-------------------------------	--------------------------------	-------------------------------	-------------------------------	-------------------------------	-------------------------------	-------------------------------

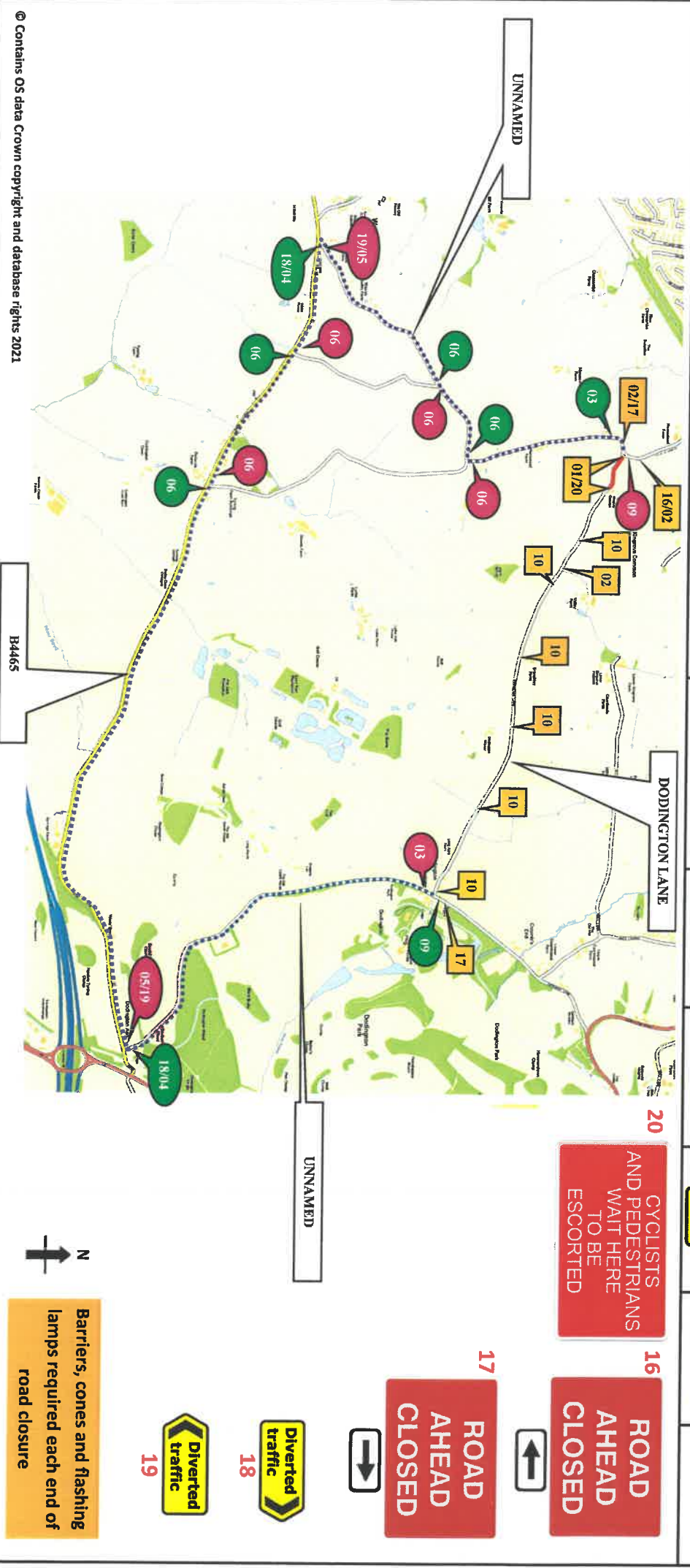

© Contains OS data Crown copyright and database rights 2021

SUNBELT RENTALS
Sunbelt Rentals UK (Traffic Management)
Kemble Airfield Enterprise Park
Cirencester Road
Kemble
GL7 6BG
03700 500 792
0845 004 7105

Note

- All equipment shall be approved and shall comply with the Department Of Transport specification, MCF011. This drawing does not show the normal road works signage that will be required as per Chapter 8.
- All signs to be in accordance with TSGRD 2002 and to minimum class retroreflective.
- Minimum height of lettering to be 60mm and sign board to be 1000mm (750mm where appropriate).

This drawing may not be copied and the information therein may not be used, or disclosed to a third party, wholly or in part with the written permission of Sunbelt Rentals UK (Traffic Management).

CROWN COPYRIGHT DATA REPRODUCED BY PERMISSION OF THE CONTROLLER OF HMSO			
CLIENT DETAILS	REP/DEPOT	DRAWN BY	
OPENREACH	BW-228	BW-228	
DATE	SHEET No	VERSION NUMBER	
01/08/2021	1 OF 1	XXX	
AMENDED DATE	AMENDED BY	SCALE	
Xx/xx/xxxx	XXXX-XXXX	NOT TO SCALE	
This layout is for installation by NRSWA, Lantra 12A,12B,12D qualified persons.			
ADDRESS		ADDRESS	
DODDINGTON LANE		DODDINGTON LANE	
BRISTOL		BRISTOL	
BS37 6SB		BS37 6SB	
BUS ROUTE AFFECTED			
ROAD CLOSURE		ROAD CLOSURE LENGTH (APPROX)	
ROAD CLOSURE WIDTH (APPROX)		191 M	
Contract Number		213-S008872	