

SOUTH GLOUCESTERSHIRE COUNCIL
(Catchpot Lane, Old Sodbury) (Temporary Prohibition of Use by Vehicles and Equestrians) Order 2021

Notice is hereby given that South Gloucestershire District Council in pursuance of the provisions of section 14 of the Road Traffic Regulation Act 1984 as amended intends to make an order the effect of which will be to close, temporarily, to vehicles and equestrians that length of Catchpot Lane which extends from its junction with Chapel Lane in a south westerly direction for a distance of 35 metres.

This order is required for the following reason: in connection with the likelihood of danger to the public consequent upon carriageway defect repair works. The order will be operative from 27 July 2021 for a maximum period of eighteen months. The closure however may not be implemented for the whole of the period but only when traffic signs are in position and only for so long as is necessitated by the works which are anticipated to be of **2 days** duration.

Alternative route: Catchpot Lane, A432 Badminton Road, A46 Bath Road, B4465, Catchpot Lane and vice versa

PO Box 1953,
Bristol,
BS37 0DB

John McCormack
Monitoring Officer and Head of Legal,
Governance and Democratic Services

Go Traffic Management

This drawing has been produced for a specific project identified below and is not intended for any other purpose other than that for which it is intended.

NOTES

- All signs as per Chapter 8. Distances between signs NOT to scale for purpose of clarity working spaces.
- The purpose of the Traffic Management Plan is for it to be used only as a guide and a traffic management equipment should be put in place at the start of any project or works and Road Works - Code of Practice Works and Chapter 8, i.e. Yellow Book.

Key



GTM
Go Traffic Management

TRAFFIC MANAGEMENT PLAN



ROAD CLOSURE

PROJECT NO.	AS DRAWN
DATE	DESCRIPTION
A 21/04/20	

Design: V. Fowler
Home: J. McVey
Date: 21/04/2020

Project Name: Mulberry Tree Cottage, Catchpot Lane, Old Sodbury, South Glouce, BS37 6SQ

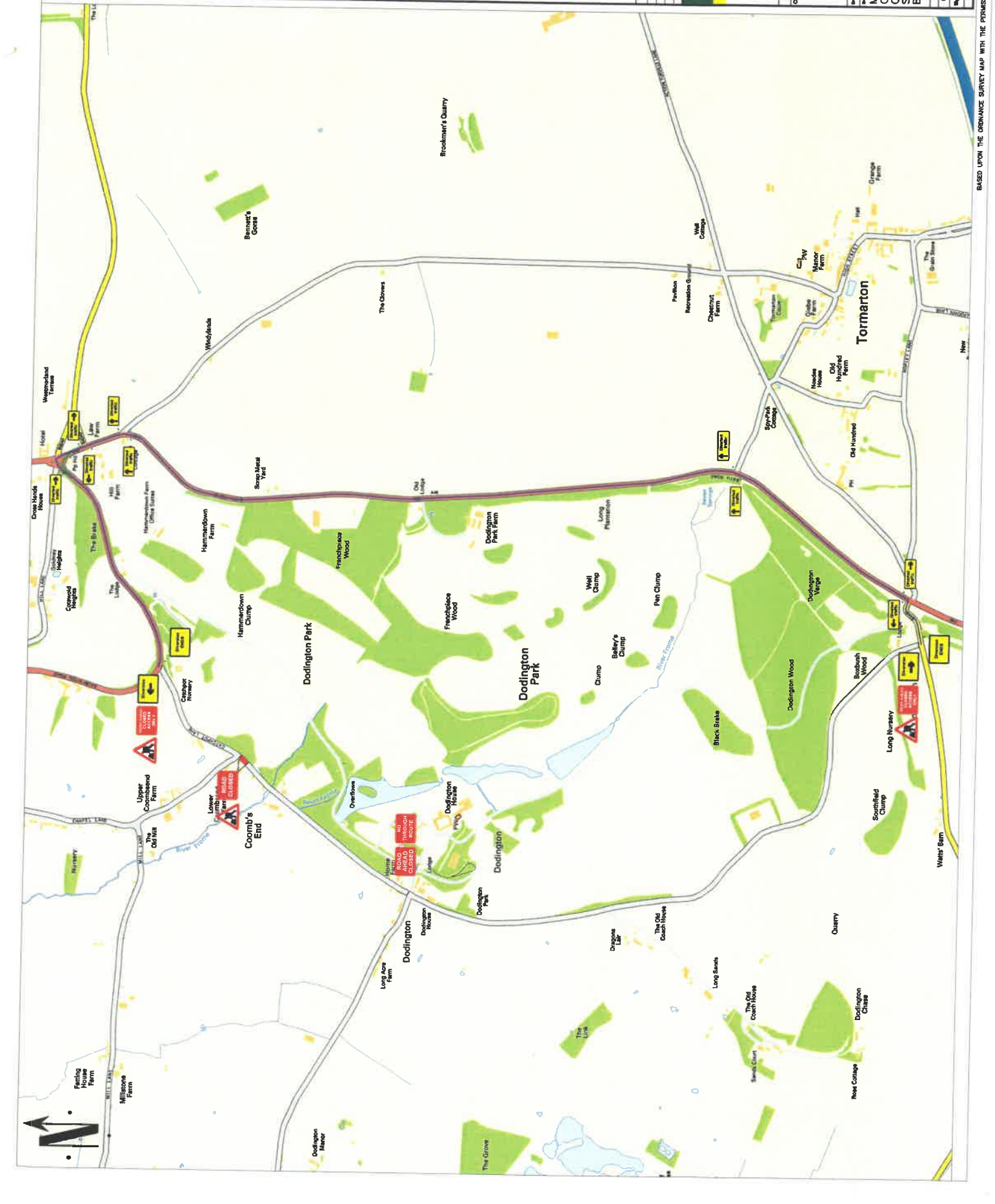

SOUTH GLOUCESTERSHIRE COUNCIL
(Hatters Lane, Chipping Sodbury) (Temporary Prohibition of Use by Vehicles)
Order 2021

Notice is hereby given that South Gloucestershire District Council in pursuance of the provisions of section 14 of the Road Traffic Regulation Act 1984 as amended intends to make an order the effect of which will be to close, temporarily, to vehicles that length of Hatters Lane which extends from a point 90 metres north east of its junction with B4060 in a generally easterly direction for a distance of 15 metres.

This order is required for the following reason: in connection with fibre cabling works. The order will be operative from 31 August 2021 for a maximum period of eighteen months. The closure however may not be implemented for the whole of the period but only when traffic signs are in position and only for so long as is necessitated by the works which are anticipated to be of 1 day duration, between the hours of 9.30am and 3.30pm.

Alternative route: B4060, Wickwar Road, St Johns Way, Horton Road, Hatters Lane and vice versa

PO Box 1953,
Bristol,
BS37 0DB

John McCormack
Monitoring Officer and Head of Legal,
Governance and Democratic Services



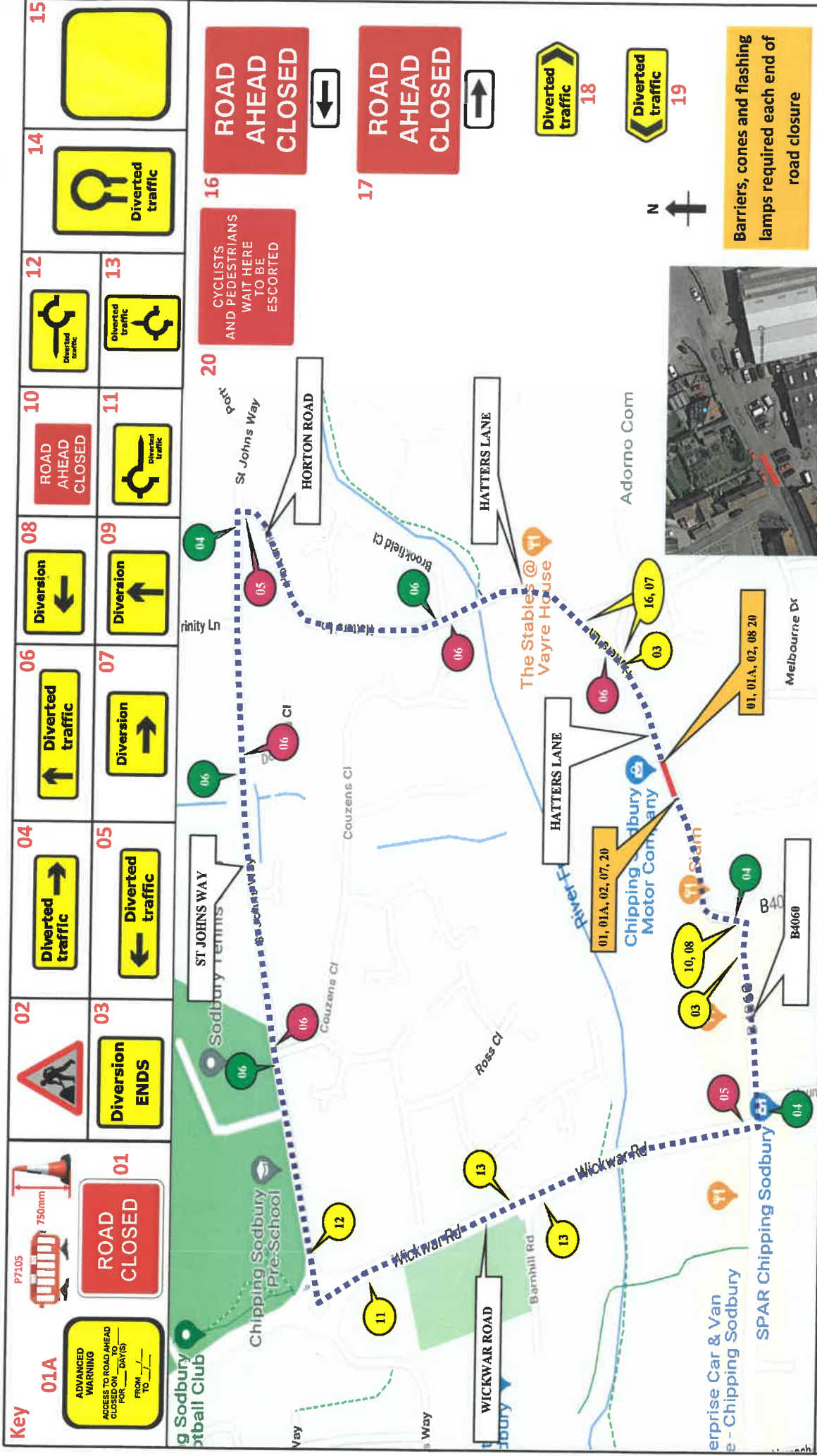

ROAD CLOSURE		CLOCKWISE DIVERSION
DIVERSION		ANTI-CLOCKWISE DIVERSION
		ROAD CLOSURE SIGN
ROAD CLOSURE LENGTH (APPROX)		15M
ROAD CLOSURE WIDTH (APPROX)		3.7M

Contract Number 213-S008130

BUS ROUTE AFFECTED

CROWN COPYRIGHT DATA REPRODUCED BY PERMISSION OF THE CONTROLLER OF HMSO			
CLIENT DETAILS	REP/DEPOT	DRAWN BY	ADDRESS
Openreach	NB/213	NB/213	HATTERS LANE CHIPPING SODBURY BS37 6AA
DATE	SHEET NO	VERSION NUMBER	
28/04/2021	1 OF 1	001	
AMENDED DATE	AMENDED BY	SCALE	
Xx/xx/xxxx	XXXX-XXXX	NOT TO SCALE	
This layout is for installation by NRSWA, Lantra 12A, 12B, 12D qualified persons.			

Note

- All equipment shall be approved and shall comply with the Department of Transport specification MCD0111. This drawing does not show the normal road works signage that will be required as per Chapter 8.
- All signs to be in accordance with TSGRD 2002 and to minimum class reflective.
- Minimum height of lettering to be 50mm and sign boards to be 3000mm (750mm where appropriate). This drawing is protected by copyright and the information contained therein is confidential. This drawing may not be copied and the information therein may not be used, or disclosed to a third party, wholly or in part with the written permission of Sunbelt Rentals UK (Traffic Management).

SUNBELT RENTALS

Sunbelt Rentals UK (Traffic Management)
 Kemble Airfield Enterprise Park
 Cirencester Road
 Kemble
 GL7 6BQ
 ☎ 03700 500 792
 📠 0845 004 7105

Town Police Clauses Act - Temporary Road Closure - PT.7002 - Chipping Sodbury Music in the Street Festival - Broad Street, Chipping Sodbury

Dear Sir/Madam

This Council has received an application for the temporary closure of the following street in Chipping Sodbury :-

Broad Street that length which extends from its junction with Horse Street to its junction with High Street

Plan attached for your information.

The date and time(s) of the closures are:- 18:00 hours – 23:15 hours, Saturday 28th August 2021.

Proposed alternative route for vehicles: Wickwar Road, St Johns Way, Hounds Road, Horse Street, Hatters Lane (cars only), Gorlands Road (Buses etc.) and vice versa

The road is to be closed for the holding of the Chipping Sodbury Music in the street Festival and any queries regarding the proposed order should, in the first instance, be addressed to this Department.

I would be grateful for your written confirmation that you have no objection to the proposed closure. If I do not receive a reply within the next **Twenty One Days** however, I will assume that the order can proceed as detailed above.

Should it be the case that you wish to object to this application would you please let me have the reasons for your objection in full. The reasons will be quoted in the letter to the applicant refusing the application.

Please note that the usual exemption for emergency vehicles will be contained in the order if it proceeds.
Yours faithfully

Kind regards

Grace Marsden

Legal Technician
Chief Executive & Corporate Resources Department
Legal, Governance & Democratic Services
PO Box 1953
Bristol
BS37 0DB

Tel: 01454 866324

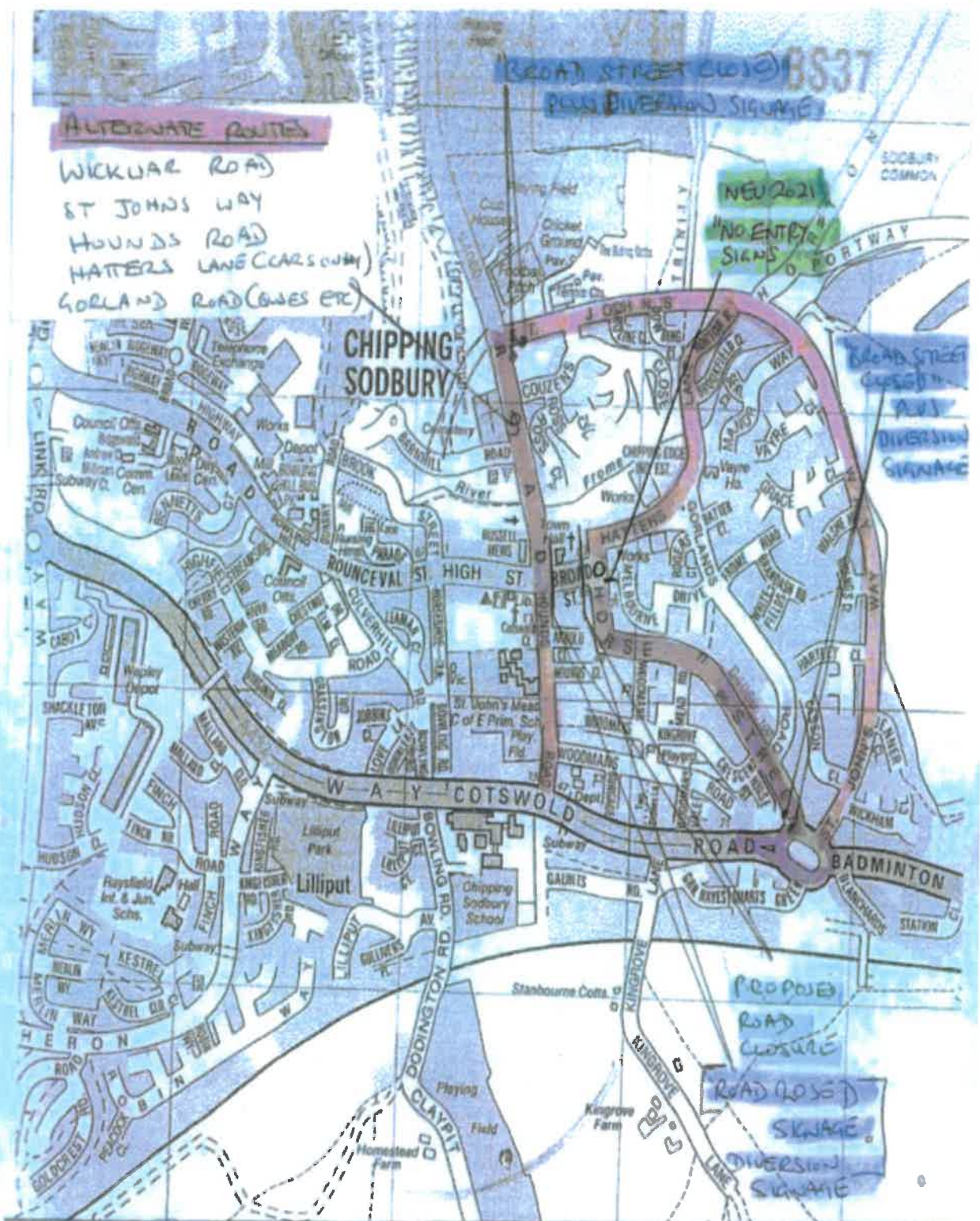

ALTERNATE ROUTES

- WICKWAR ROAD
- ST JOHNS WAY
- HOUNDS ROAD
- HATTERS LANE (CARS ONLY)
- GORLAND ROAD (BUSES ETC)

ROAD STREET CLOSED BS37
PLUS RIVER AND SQUARES

NEU 2021
NO ENTRY SIGNS

ROAD STREET CLOSED
PLUS
DIVERSION SIGNAGE

PROPOSED
ROAD CLOSURE
ROAD CLOSED
SIGNAGE
DIVERSION
SIGNAGE

CHIPPING
SOBBURY

W-A-Y COTSWOLD

BADMINTON

ROUNCEVAL ST

HIGH ST

CLAYHILL

ROAD

WICKWAR

ROAD

WICKWAR

ROAD

WICKWAR

ROAD

WICKWAR

ROAD

WICKWAR

ROAD

WICKWAR

ROAD

WICKWAR

ROAD

WICKWAR

ROAD

WICKWAR

ROAD

WICKWAR

ROAD

WICKWAR

ROAD

WICKWAR

ROAD

WICKWAR

ROAD